

COOLEEDGE™

SURFACES - Flush Mount

Luminous ceilings that deliver immersive illumination experiences from wall to wall



CONTINUOUS

Continuous

Mounts directly to each wall to form a continuous luminous ceiling or fill a cavity with limitless scalability

Immersive Illumination

Delivers a surprising amount of light without visual discomfort

Code Friendly

Coated polyester fabric and fully certified lighting system eliminates regulatory issues where other materials or component-only lighting certification cause problems

No Special Site Requirements

Knitted fabric is easily stretched and held in place without need to remove equipment or isolate the space

First Time Right Install

Field adjustable accommodates unexpected obstacles and altered site dimensions – no need for 2nd attempts

Quick & Clean

Avoid the messes caused by drywall construction and delays waiting for surface prep.

Adaptable

Choice of a single color temperature and tunable white options - all dimmable to 0.05%

A COMPLETE SOLUTION

Integration

Creating good lighting is about more than just putting a light source behind a material. The light source and materials have been tested together to deliver proven performance that incorporates unique knowledge about the interaction between light, material properties, and the geometry of luminous surfaces

Predictable Illumination

Photometric files are available for all standard product options to make specification simple and ensure adherence with design requirements.

More Than a Box of Parts

Cooledge manages the installation process from specification to commissioning saving valuable time otherwise wasted coordinating multiple suppliers



COOLEEDGE™

COOLEGE SURFACES - FLUSH MOUNT

PHOTOMETRIC HIGHLIGHTS¹

LIGHT OUTPUT² (LM/SQFT)
345 (HF), 170 (MF), 85 (LF)

LIGHT OUTPUT² (LM/SQM)
3700 (HF), 1850 (MF), 925 (LF)

CORRELATED COLOR TEMPERATURE (CCT)
2700K, 3000K, 3500K, 4000K, 5700K
Tunable White 2700K-5700K

COLOR RENDERING
CRI > 90

COLOR UNIFORMITY
Typical 2 SDCM

LUMEN MAINTENANCE²
L80 = 75,000hr (based on LM-80 & TM-21 calculations)

1 Photometric files available from cooledgelighting.com

2 Based on a 10' x 10' (3m x 3m) area >> refer to SURFACE Size Factors for other sizes

Cooledge has conducted extensive testing on the interaction between the light source and the surface materials to determine the optical and photometric properties of the SURFACE.

COOLEGE SURFACE - GENERAL

MOUNTING TYPE
Flush Mount

SURFACE MATERIAL
Polyurethane-coated knitted polyester fabric

FABRIC TENSIONING PROFILE
Flexible PVC

LIGHT SOURCE
Cooledge TILE Interior or TILE Tunable White

DUST PLY INCLUDED
Yes

MAXIMUM SEAMLESS DIMENSIONS
16ft (4.9m) x 164ft (50m) (W x L)

MINIMUM CAVITY DEPTH
4in (100mm)

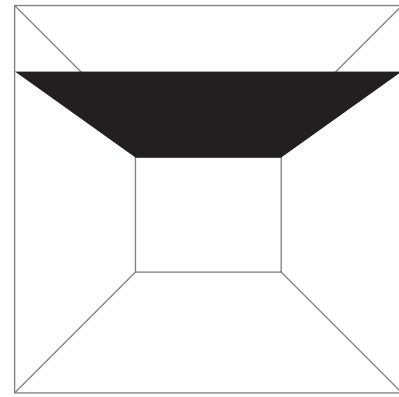

COOLEGE SURFACE OVERVIEW

Cooledge SURFACE - Flush Mount includes the illumination source, mounting hardware, and light emitting surface materials

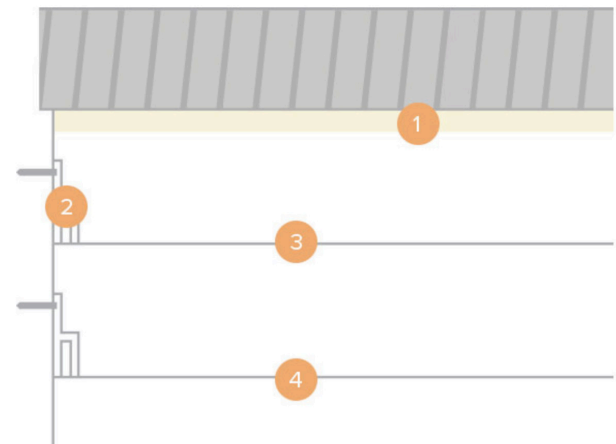

- 1 **COOLEGE TILE Lighting System**
Includes all accessories and LED Drivers required
- 2 **PVC Fabric Tensioning Profile**
- 3 **Dust Ply Layer**
- 4 **Coated Polyester Knitted Fabric**

